



F-Style Large Capacity Ice Storage Bins

Models

F-700

F-1300

F-1325

F-1650

FC-1350



F-1300 Ice Storage Bin



FC-1350 Ice Storage Bin & Cart System

Standard Features

Manitowoc F-style large capacity ice storage bins are equipped with a sliding ice gate for increased employee safety, easier ice removal, and reduced spillage.

Choose a bin width from 30", 48" or 60", with relative ice storage capacities of 680 lbs., 1320 lbs. or up to 1660 lbs.

Sliding Ice Gate

- Controls ice flow into snout for easy removal with either scoop or shovel
- Returns easily to full down position

Quality Construction

- Stainless steel exterior
- Heavy-duty welded construction
- Non-CFC foamed-in-place insulation
- Impact-resistant sliding windows for easy bin inspection

Durable Polyethylene Lift Door

- Ball catch hinge holds bin door open when scooping ice
- Eliminates sharp corners and gaskets
- Provides outstanding durability
- Offers maximum access for fast, easy ice removal

Warranty

Bin & Accessories: 3 Year Parts & Labor

Carts: 2 Year Parts & Labor





F-Style Large Capacity Ice Storage Bins

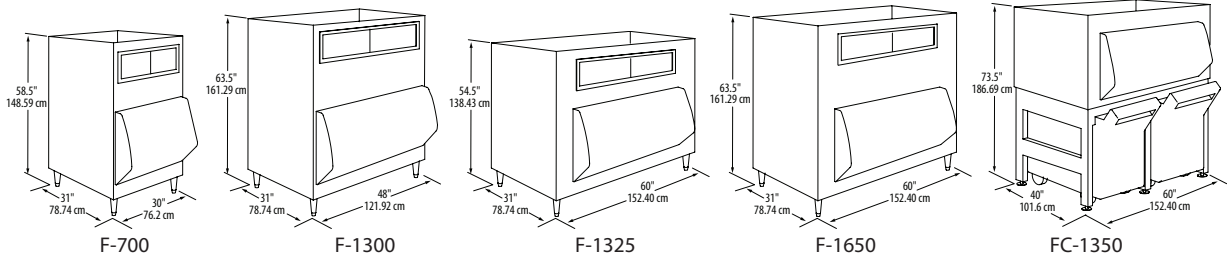

Standard Equipment

F-Series Bins Include: set of (4) 6" bin legs, ice scoop, stainless steel adapter for 30" or 48" S-Series Cubers (see chart)

FC-1350 Bin and Cart System Includes:

bin, base, (2) 240 lb. capacity carts with lids, set of (6) flanged legs, Ice Paddle, stainless steel adapter for 30" or 48" S-Series Cubers (see chart)

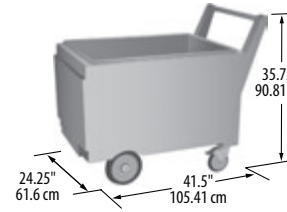

Accessories

- | Model # | Description |
|---------|--|
| K-00412 | Paddle 46.5" (118.11 cm) length |
| K-00413 | 82 oz. Scoop |
| K-00414 | Shovel 36" (91.44 cm) Length |
| K-00416 | Totes Ice Carrier, Set of 6 (25 lb. capacity per tote)
Totes for use with FC-1350 cart. One set of 6 required per cart. |

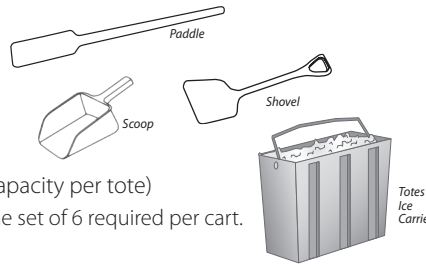

Storage Capacity

	Model	AHRI* Lbs. / kg	Cu. Ft.
30"	F-700	680	20.3
		308	
48"	F-1300	1320	38.0
		599	
60"	F-1325	1325	39.7
		601	
	F-1650	1660	47.7
		753	
FC-1350	1350	39.9	
	612		

*AHRI storage capacity for bins is based on 80% of total volume in cubic feet x 30 lb./ft.³ average density of ice.

Ice Deflectors — Required

S-Series Cuber Model	Ice Deflector Model Number
S-450, S-500, S-600, S-850, S-1000, S-1200	K-00347
S-1400, S-1600, S-1800	K-00349
S-1470C, S-1870C, S-2170C	K-00382 (for single ice machine) K-00383 (for side-by-side ice machines)
S-3070C, S-3300	K-00391

Bin Adapters

Bin	Model	Ice Makers on Bin	Ice Machine									
			S-300	S-450	S-500	S-600	S-850 S-1000 S-1200	S-680C S-800C S-1000C S-1200C	S-1470C S-1870C S-2170C	S-1400 S-1600 S-1800	Q-1800 Stackable	RF-0300 RF-0650 RF-1200
F-700	F-700	1	K-303000 Single Head Adapter (Included with Bin)						N/A	N/A	K-302500	N/A
			K-483048 Single Head Adapter (Included with Bin)								K-482500	Adapter Not Required
F-1300	F-1300	1	K-603048 Single Head Adapter (Included with Bin)								K-602500	K-604800
			2*	K-603030 Side-by-Side 30" Head Adapter						N/A	N/A	N/A
F-1325	F-1325	1	K-603048 Single Head Adapter (Included with Bin)								K-602500	K-604800
			2*	K-603030 Side-by-Side 30" Head Adapter						N/A	N/A	N/A
F-1650	F-1650	1	K-603048 Single Head Adapter (Included with Bin)								K-602500	K-604800
			2*	K-603030 Side-by-Side 30" Head Adapter						N/A	N/A	N/A
FC-1350	FC-1350	1	K-613048 Single Head Adapter (Included with Bin)								K-612500	K-614800
			2*	K-613030 Side-by-Side 30" Head Adapter						N/A	N/A	N/A

* Only for use with water-cooled and remote ice machines. Check ice machine clearance requirements.